

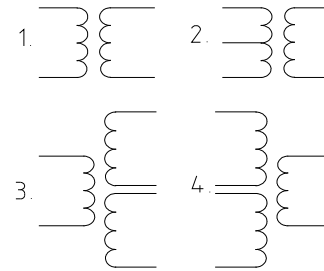

**ELECTRIC CHARACTERISTICS**

Rated frequency	50/60 Hz
Electric strength	4kV
Insulation class	B
Max. ambient temperature	70°C

**ELECTRIC DIAGRAM**

EI 48	Max. output power (VA)	PRI (V)	SEC (V)	Short circuit protection
-12/...	7	220-230	3-24	Inherently short circuit proof
-12A/...	10	110-480	3-24	Not short circuit proof
-12F/...	10,5	24-400	3-24	Non-Inherently short-circuit proof
-13F/...	10,5	24-240	3-24	Non-Inherently short-circuit proof
-32A/...	11,4	24-430	3-24	Not short circuit proof
-32E/...	10	230	3-24	Not short circuit proof
-32F/...	13	110-230	3-24	Non-Inherently short-circuit proof
-33F/...	14	24-240	3-31	Non-Inherently short-circuit proof

Approved to EN 61558  
Safety class II

**CONNECTION**

Solder pins Ø 0,8 mm

**MECHANICAL DIMENSIONS (mm)**

EI 48	A	B	C	D	E	F	G	H	I	J	K	L	Weight (g)	Case
-12/...	51,2	43,2	-	-	-	-	-	37,8	-	27,5	-	27,5	290	O
-13/...	51,2	43,2	60	4,2	69,2	-	-	37,8	-	27,5	-	27,5	290	K
-21/...	51,2	43	62	3,5	75	7	1,5	38,6	8,7	20,7	-	27,5	290	V
-31/...	51,2	43	62	3,5	75	7	1,5	39,3	8,7	20,7	-	27,5	335	V
-32/...	50,3	42,5	-	-	-	-	-	38,5	-	27,5	-	27,5	335	O
-33/...	50,3	42,5	60	4,2	69,2	-	-	38,5	-	27,5	-	27,5	335	K

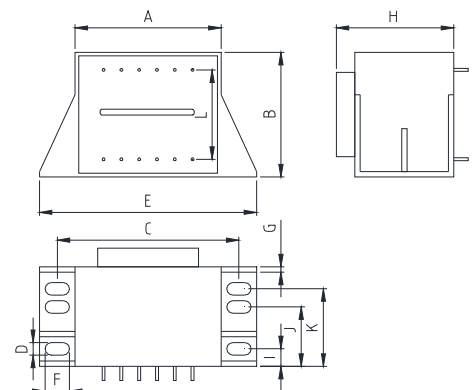
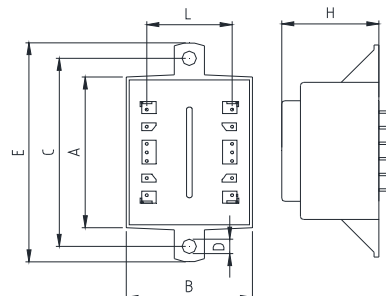
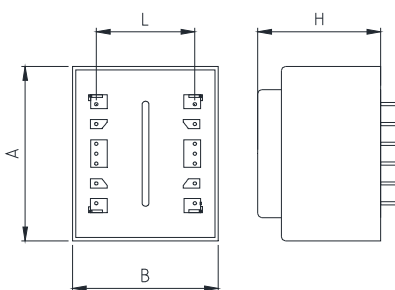
**CASE "O"**
**CASE "K"**
**CASE "V"**

Further versions, prim. or sec. voltages, pin configurations on request.